

TAMIL NADU HOUSING BOARD SPECIAL DIVISION-I
 PART LAYOUT FOR PROPOSED PLOT IN CLUSTER HOUSES
 SCHEME AT M.K.B. NAGAR MADRAS.
 SCALE: 1:400 (33 FT. TO AN INCH)

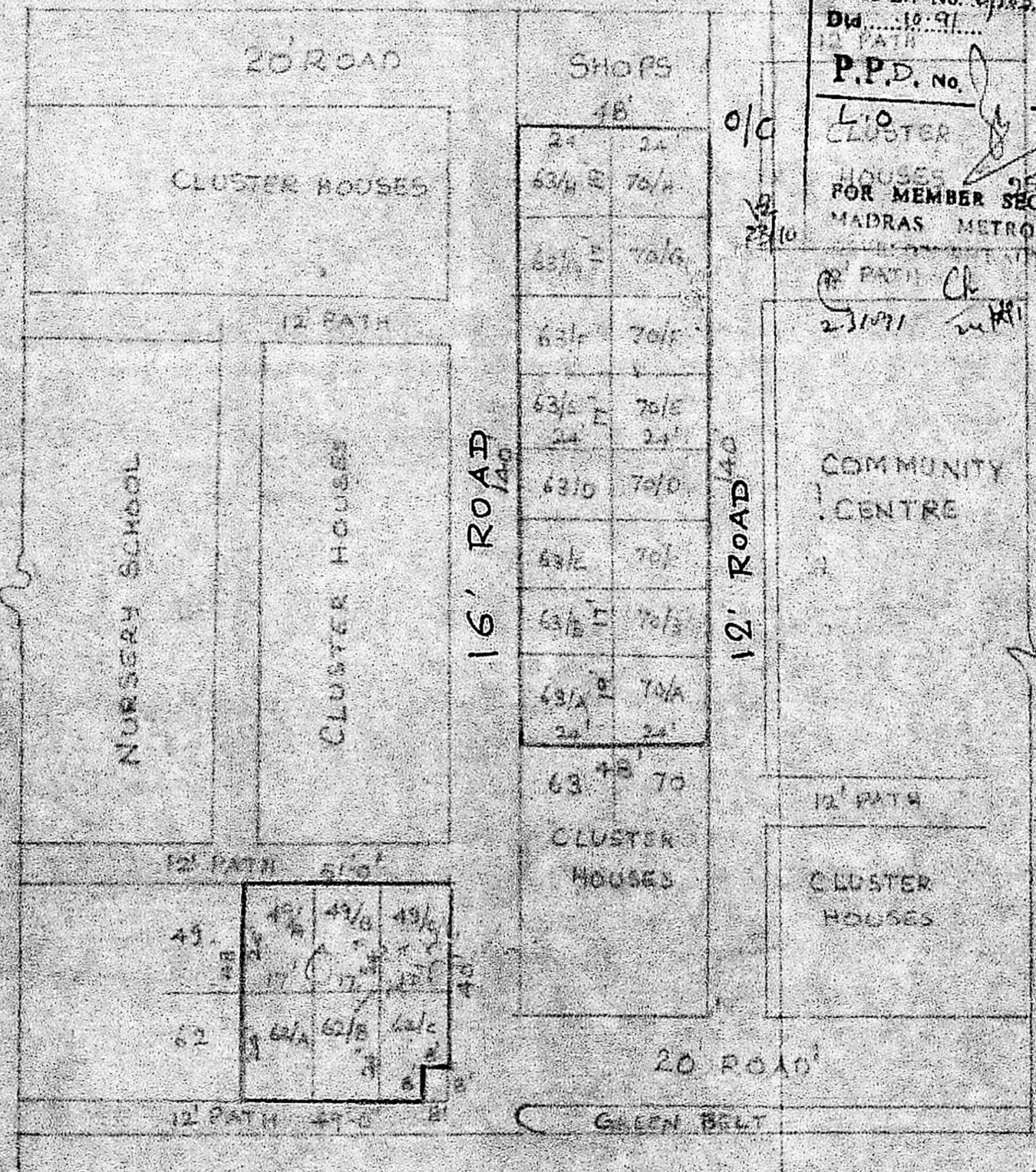

APPROVED
 Subject to the conditions in this
 Office Lr. No. 2/18595/79
 Dtd. 10.9.79
 12' PATH
P.P.D. No. 69
 L.O. CLUSTER HOUSES FOR MEMBER SECRETARY
 MADRAS METROPOLITAN CORPORATION
 23/10/79

T.N.H.B./T.P. No 28/90
 FILE NO TPI/52393/89



REFERENCE

PLOT NOS	SIZE	EXTENT SQ. FT.
49A & 49/B	17' x 22'	0.0408
49/C	17' x 22'	0.0408
62/A & 62/B	17' x 22'	0.0408
62/C	17' x 22' - 8' x 8'	0.0344
63/A	19' x 24'	0.0456
63/B TO 63/G	17' x 24'	0.0408
63/H	19' x 24'	0.0456
70/A	19' x 24'	0.0456
70/B TO 70/G	17' x 24'	0.0408
70/H	19' x 24'	0.0456

PROPOSED HOUSE SITES.
 (B.W.S.)

TRACED BY: *[Signature]* 23/11/79
 CONFIRMED BY: *[Signature]* 28.2.79
 ASST PLANNER | TOWN PLANNER | SENIOR PLANNER | CHIEF ENGINEER
 1/16/79 | H.S. | R.E. & ADO | 8/7/90